



IMV-1401

The Robertshaw® S-55 Water Valve Series is designed to prevent foreign material from interfering with the drain function in automatic dishwashers and commercial icemakers.

Features and Benefits

- Direct acting solenoid valves provide high flow at low head pressure
- Encapsulated coil provides high mechanical and dielectric strength, and is moisture resistant
- Bodies are made of polypro to withstand a variety of harsh water conditions
- Suitable for applications using water at temperatures up to 160°F (71°C)

REPLACEMENT INFORMATION

Part Numbers	Replaces	Factory Number
IMV-1401	Scotsman 11051401	K-55017-9
IMV-1402	Scotsman 11051402	K-55017-11

SPECIFICATIONS

Part Numbers	Description	Flow Rate	Inlet	Outlet	Operating Pressure	Terminals	Body Material	Electrical Rating	Power
IMV-1401	Commercial Ice Machine Water Valve S-55	NA	11/16" ID Hose	5/8" ID Hose	0 PSI to 7 PSI	1/4" Male	Polypro	208/230V AC 60 Hz	38 Watts
IMV-1402	Commercial Ice Machine Water Valve S-55	NA	11/16" ID Hose	5/8" ID Hose	0 PSI to 7 PSI	1/4" Male	Polypro	120V AC 60 Hz	28 Watts

PRODUCT DRAWINGS

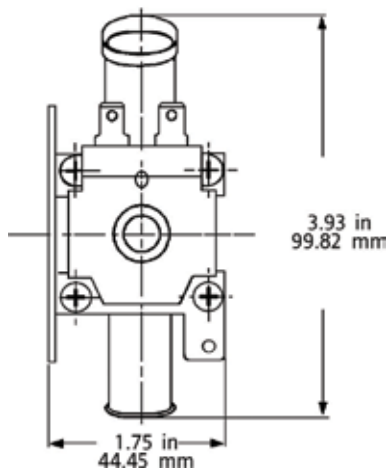
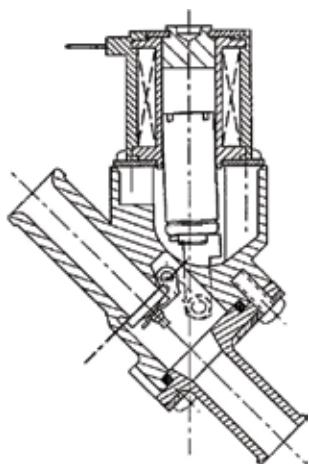
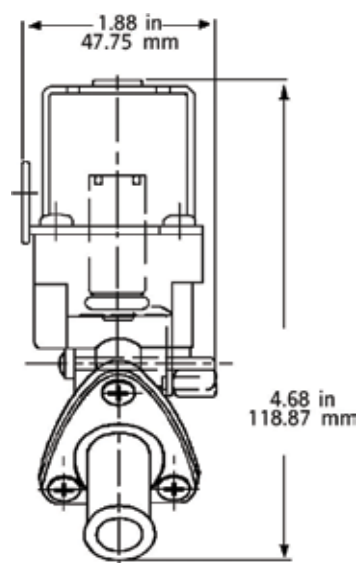
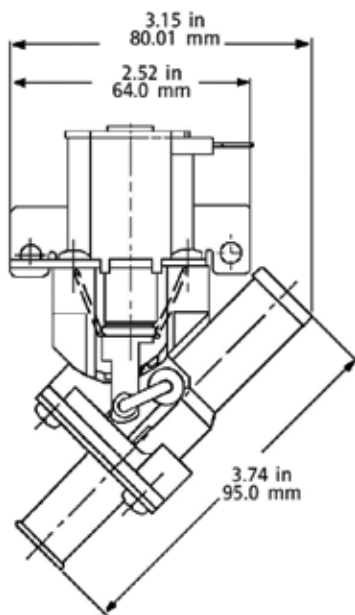
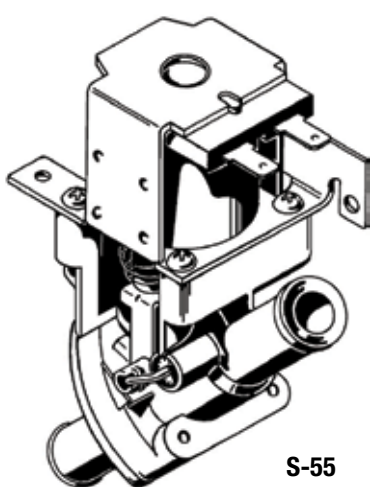

UNI-LINE®

191 E. North Avenue
Carol Stream, Illinois 60188 USA
Customer Service Telephone 1.800.304.6563
Customer Service Facsimile 1.800.426.0804
HVACCustomerService@Invensys.com

For Technical Service
Telephone 1.800.445.8299
Facsimile 1.630.260.7294
TechnicalService@Invensys.com

Uni-Line® and Robertshaw® are trademarks of Robertshaw Controls Co. its subsidiaries and/or affiliated companies. All other brands mentioned may be the trademarks of their respective owners.

www.Uni-Line.com
www.InvensysControls.com
©2014 Robertshaw Controls Co.
03/14 – 150-2436