

SERVICE PARTS

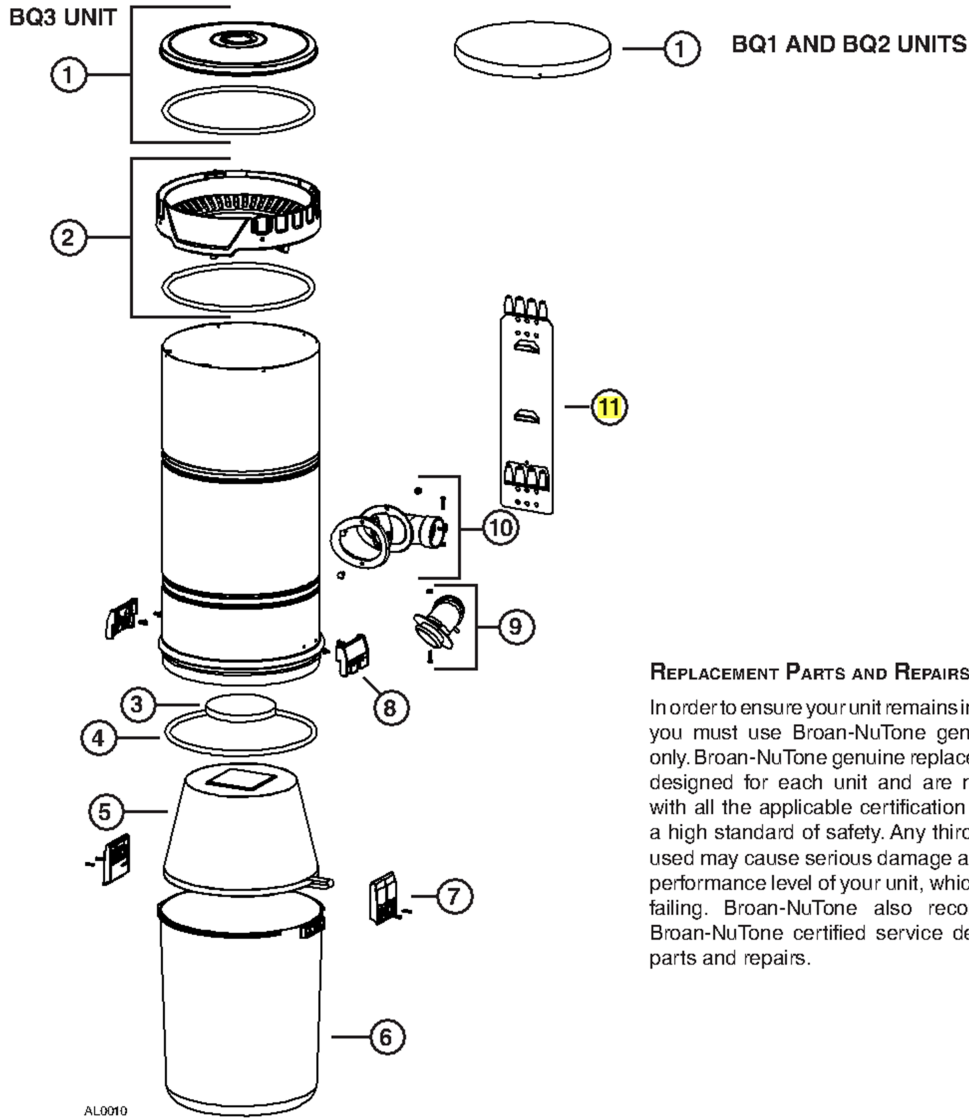

REPLACEMENT PARTS AND REPAIRS

In order to ensure your unit remains in good working condition, you must use Broan-NuTone genuine replacement parts only. Broan-NuTone genuine replacement parts are specially designed for each unit and are manufactured to comply with all the applicable certification standards and maintain a high standard of safety. Any third party replacement part used may cause serious damage and drastically reduce the performance level of your unit, which will result in premature failing. Broan-NuTone also recommends to contact a Broan-NuTone certified service depot for all replacement parts and repairs.

KEY NO.	PART NO.	DESCRIPTION	BQ1	BQ2	BQ3
1	S10941409	BQ3 TOP CAP ASSEMBLY (INCLUDING ITEM 4) (UPPER PART)			1
	S10941417	BQ2 TOP CAP ASSEMBLY		1	
	S10941397	BQ1 TOP CAP ASSEMBLY	1		
2	S10941398	BQ3 TOP CAP ASSEMBLY (INCLUDING ITEM 4) (LOWER PART)			1
3	S10941399	MOTOR FOAM FILTER WITH FASTENER	1	1	1
4	S10941400	GASKET	1	1	3
5	S10941401	PERMANENT FILTER		1	1
6	S99670648	DEBRIS PAIL (INCLUDING KEY NO. 7)	1	1	1
7	S10941199	LATCH AND SCREWS	2	2	2
8	S10941404	LATCH KEEPER WITH SCREWS	2	2	2
9	S10941405	BAG ADAPTER WITH NUT AND SCREW	1		
10	S10941406	INTAKE ELBOW WITH GASKET, SCREWS, AND NUTS	1	1	1
11	S30390555	UNIT SUPPORT BRACKET	1	1	1
12	391C	DISPOSABLE BAG (SET OF 3, NOT SHOWN)	1		

NOTE: Order service parts by "Part No." — not by "Key No."